



20718-00001 Rev ad

## **WARNING!**

Always shut down your Segway PT and unplug the charge cord before performing any maintenance or installing any part or accessory. Follow these instructions carefully. Failure to follow these instructions could damage your Segway PT and render it unsafe to use.

The Universal Cargo Plate and/or Hard Side Case & Structure reduces the riders range of movement, increases the total width of the Segway PT and reduces the rider's ability to lean into turns and/or lean uphill to maintain lateral stability. This may increase the risk of collision. The Universal Cargo Plate and/or Hard Side Cases & Structure may prevent the rider from dismounting to the sides in the event of a fall, collision, loss of traction, Safety Shutdown or other emergency. For these reasons, riding a Segway PT with the Universal Cargo Plate and/or Hard Side Cases & Structure increases risk of injury.

All Segway PT riders must first watch the Safety Video and read the Riders' Guide. Riders using a Segway PT with the Universal Cargo Plate and/or Hard Side Cases & Structure installed must be especially careful to avoid slippery surfaces and obstacles, not ride on steep slopes, and not take fast turns.

Do not exceed these weight limits: **Maximum total payload** (weight of rider plus all cargo): 260 lbs (118 kg); **Maximum cargo weight limits:** Handlebar bag – 10 lbs (4.5 kg); Universal Cargo Plate – 15lbs (6.8kg) each side; Hard Side Case & Structure – 11lbs (5 kg) each side. Exceeding these weight limits, especially when riding on slopes or uneven surfaces, increases risk of falling and risk of injury. Do not sit or stand on the Universal Cargo Plate and/or Hard Side Cases & Structure.

Carrying cargo with the Universal Cargo Plate and/or Hard Side Cases & Structure will change the behavior of the Segway PT. The greater the weight, the more the change. You should acquaint yourself with these changes while riding at slow speeds.

Never let go of a Segway PT in Balance Mode, because the Segway PT will travel some distance on its own, risking injury or damage.

The Universal Cargo Plate and/or Hard Side Cases & Structure should be used only with the Segway PT i2 or x2 models.

# Segway<sup>®</sup> PT Cargo

## i2 Lower Cargo Frame

20412-00001

## Universal Cargo Plate

20413-00001

## Hard Side Cases & Structure

20419-00001

## Assembly Instructions

# i2 Lower Cargo Frame

## Installing the i2 Lower Cargo Frame

<b>Required:</b>	Torque wrench with 4mm hex bit
<b>Included with kit:</b>	(2) i2 Lower Cargo Frame (6) 35mm hex fasteners

1. Make sure the Segway PT is unplugged and powered off.
2. Using a 4mm hex wrench, remove the 3 fasteners which attach the Gearbox Cover to the Gearbox and put them in a safe place as you may need them in the future. See Figure 1.

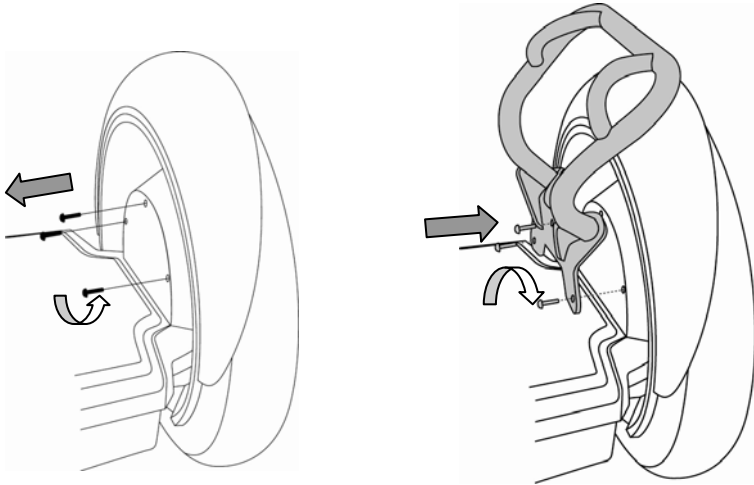

**Figure 1. Remove Gearbox Cover Fasteners and Installing the i2 Lower Cargo Frame**

3. Position the i2 Lower Cargo Frame so it aligns with the holes in the Gearbox Cover.
4. Thread 3 of the included 35mm hex fasteners through the i2 Lower Cargo Frame to the Gearbox Cover. Tighten the fasteners to 6.0 N-m (4.4 ft-lbf). See Figure 1.

## Note:

Please be prepared for your Segway PT to behave differently with cargo attached. Read the warning labels and the cover of this manual carefully, and ride safely.

- Slide the Givi Bag onto the guides and tilt the upper portion of the bag towards the wedge at the top of the Structure.

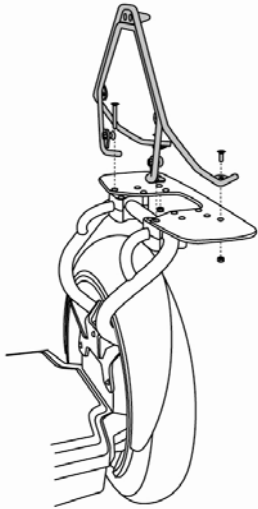

**Figure 5. Installing the Hard Side Case Structure.**



**Figure 6. Positioning the Hard Side Case for installation.**

- The Hard Side Case will lock onto the wedge at the top of the structure. You may need to use considerable force to secure the case onto the wedge. If the bag will not secure, open the lid and depress the red locking actuator while securing the case onto the wedge.

### Removing the Hard Side Case

- Open the lid of the Hard Side Case and depress the red locking actuator while pulling the top of the case away from the wedge at the top of the Structure. The top of the bag will release from the structure. You may need to use considerable force to release the bag.
- Slide the bag off of the guides at the bottom of the bag.

## Universal Cargo Plate

### Installing the Universal Cargo Plate

<b>Tools Required:</b>	Torque wrench with 4mm hex bit
<b>Components Required:</b>	i2 Lower Cargo Frame OR x2 Lower Cargo Frame
<b>Included with kit:</b>	(2) Universal Cargo Plate (4) Cargo Clamp Set (16) 35mm hex fasteners

- Make sure the Segway PT is unplugged and powered off.
- Position the Cargo Clamps and Cargo Plate on to the Lower Cargo Frame as shown in Figure 2. The threaded clamp should be positioned on the underside of the Cargo Frame.

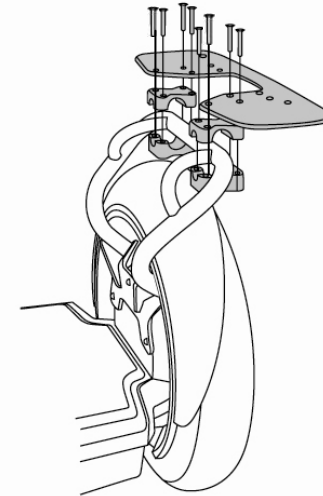

**Figure 2. Installing the Universal Cargo Plate & Clamps**

- The Cargo Plate can be installed in a Wide or Narrow Position. See Figure 3. After selecting the desired position, ensure the Cargo Plate is positioned to align with the holes in the Cargo Clamps.
- Thread 8 of the included 35mm hex fasteners through the Cargo Plate to the Cargo. Tighten the fasteners to 6.0 N-m (4.4 ft-lbf).

● Indicates fastener position

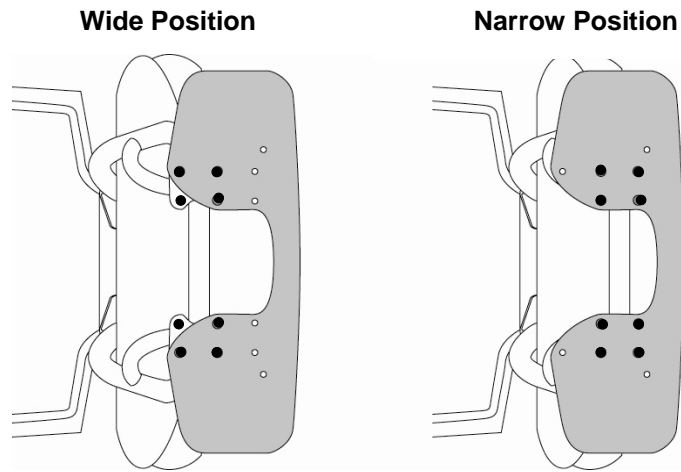

**Figure 3. Top View.  
Positioning the Universal Cargo Plate for Installation**

## Hard Side Cases & Structure

**Tools Required:** Torque wrench with 4mm hex bit

**Components Required:** i2 Lower Cargo Frame OR  
x2 Lower Cargo Frame  
Universal Cargo Plate

**Included with kit:** (2) Hard Side Cases & Structures  
(4) 40mm hex fasteners  
(12) 16mm hex fasteners  
(12) Nut

### Installing the Structure

1. Make sure the Segway PT is unplugged and powered off.

#### If the Cargo Plate is installed in the Wide Position:

2. Position the Structure to align with the holes in the Cargo Plate as shown in Figure 4.
3. Remove the 2 fasteners from the cargo clamps and plate that align with the holes in the Structure. See Figure 5.

4. Thread 2 of the included 40mm fasteners through the Structure and Cargo Plate into the cargo clamp. Tighten the fasteners to 6.0 N-m (4.4 ft-lbf).
5. Thread 3 of the included 16mm fasteners through the Structure and Cargo Plate into an included nut. Tighten the fasteners to 6.0 N-m (4.4 ft-lbf). See Figure 5.

#### If the Cargo Plate is installed in the Narrow Position:

6. Position the Structure to align with the holes in the Cargo Plate as shown in Figure 4.
7. Thread 4 of the included 16mm fasteners through the Structure and Cargo Plate into an included nut. Tighten the fasteners to 6.0 N-m (4.4 ft-lbf). See Figure 5.

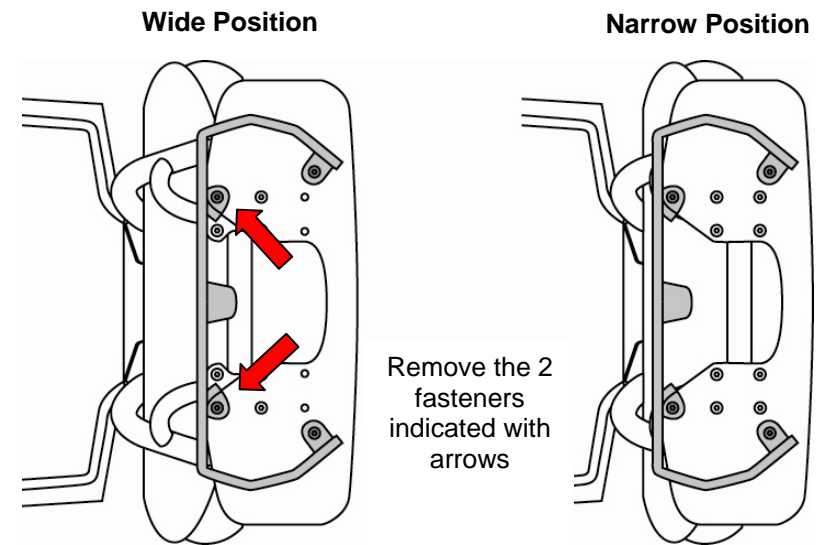

**Figure 4. Top View  
Positioning the Hard Side Case Structure for installation**

### Installing the Hard Side Case

1. Position the slots at the bottom of the Hard Side Case to align with the guides on the Structure. See Figure 6.